

Vinyl Background Application Instructions

See photos at aquariumvinyl.com/instructions

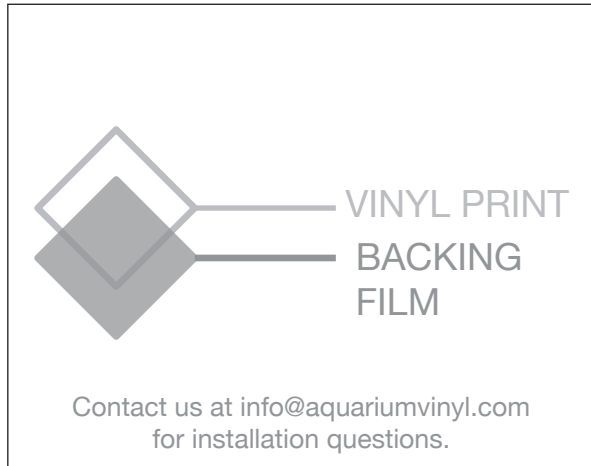

Your aquarium vinyl graphic is composed of 2 layers:

- The self-adhering vinyl print (your graphic)
- The semi-transparent backing film (to be peeled off during application), located on the front of the print

Also included is a smoothing squeegee for graphic application.

Read all instructions thoroughly before beginning.

*Note: all vinyl backgrounds and decals should be installed on the **OUTSIDE** of your tank. Do NOT install any vinyl products on the inside of your tank.*



**Backgrounds can be installed on standing tanks, as long as you can reach the entire back of the tank (the center and all four corners).*

Hardware & Prep

Clean tank surface to remove any debris with a dampened cloth & dry thoroughly. Make sure all obstructive hardware is removed. For best results, install on the **outside** of an empty tank. We recommend laying the tank face-down on a flat, study surface.*

Arrange all supplies for easy access:

- Vinyl Graphic
- Application Squeegee
- Masking Tape (*Not Included*)
- Small spray bottle filled with filtered water, or a wet cloth (*Not Included*)
- Scissors, Razor Blade, or Exacto Knife (*Optional, Not Included*)

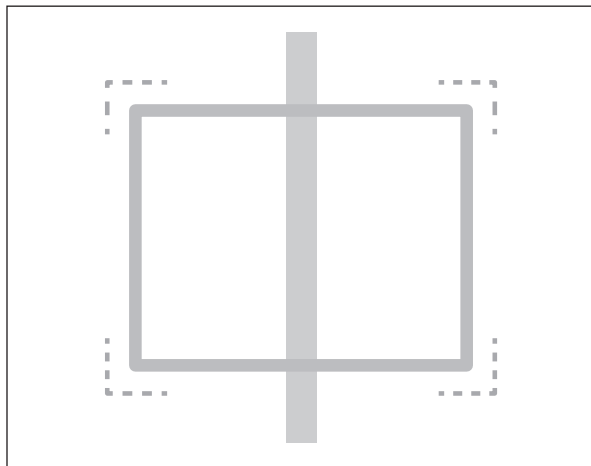

1. Anchoring

Do not peel the backing before this step! With the help of a friend, align the graphic (with the backing still attached) facedown along the **top edge** of the tank.

Using a strip of masking tape, anchor the graphic in the center.

*NOTE: If your background is larger than the glass / acrylic area, simply align the graphic to the top edge & use a pencil to lightly mark the trim line along the back of the print. Move the background to an appropriate cutting surface (such as a craft mat or cutting board) & carefully cut the excess material off of the bottom edge using an Exacto knife, razor blade or scissors **BEFORE APPLYING** the background to the tank. **DO NOT** attempt to cut the background while it is on the tank.*

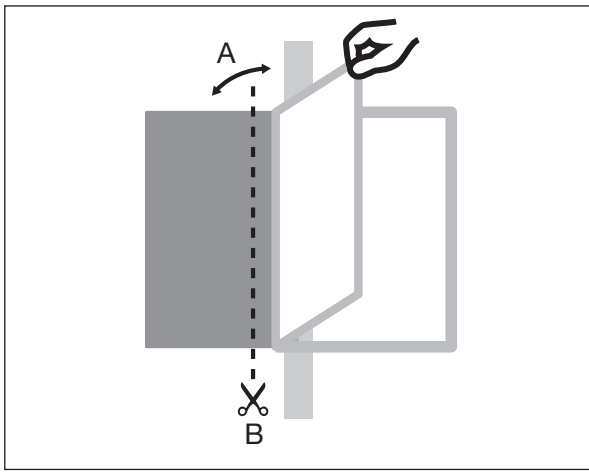

2. Trim Backing

(A) Carefully peel back the vinyl print from the semi-transparent backing of one side.

(B) Trim the exposed backing up to the tape, taking care not to cut the graphic.

(C) To give the material more flexibility during application, **lightly spray the glass using a spray bottle filled with filtered water** (RO/DI if you have it) before applying the graphic.

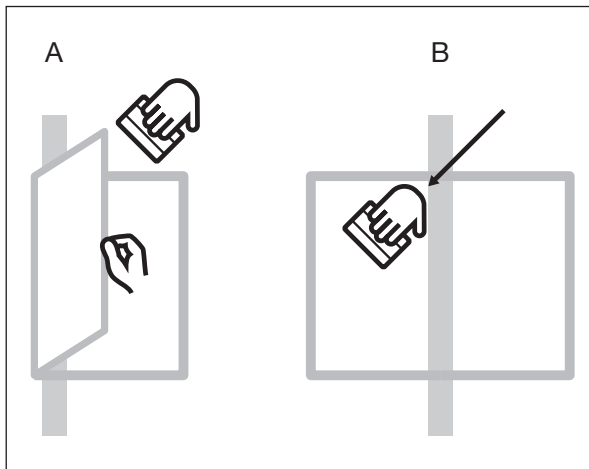

3. Apply Vinyl

(A) Hold the now exposed graphic taut by the edge.

(B) Use the included squeegee to slowly work the adhering side onto the tank surface at an angle from top to bottom, working from the center of the graphic outwards to the edges. Vinyl should be applied in slow, controlled, even strokes to work out any bubbles or wrinkles.

NOTE: In the event of a bubble, don't panic! You can simply peel back the material and use the squeegee to gently push the air out towards the edges. Using water aids in this process.

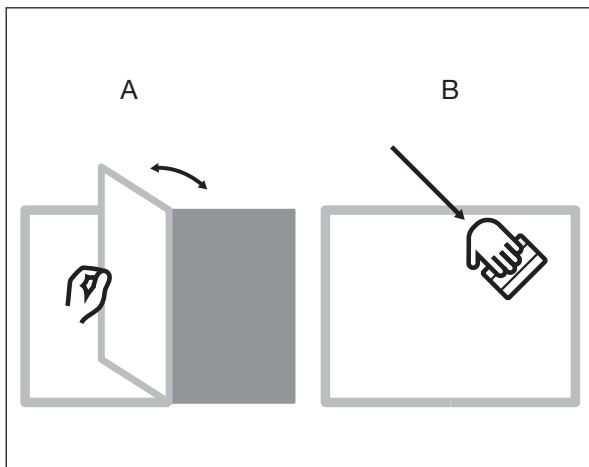

4. Repeat Application

(A) With first side applied, remove masking tape strip and peel back the graphic. Remove the remaining backing.

(B) Repeat Step 3 to apply the remaining vinyl print.

NOTE: Don't worry if you can't work out all of the small bubbles - those tend to settle out with time.

5. SUCCESS!

Your vinyl is installed & ready for action! We'd love to see it! Email a photo to info@aquariumvinyl.com, or share it with us on social media get a **15% OFF** your next purchase.

6. Removal & Storage

Do not bend the corners. Apply 3" to 4" of scotch tape onto any corner of the background. Pull the extended tape to lift the graphic from the surface. If a crease or bend occurs, try bending the material in the opposite direction to flatten. If you plan to reuse the product, store rolled up in its original tube with the adhering side on the inside of the roll. Rinse or wipe adhering side with a wet cloth to remove any debris before re-applying.